

BRUCHA panel FP-F

facade concealed fastened / non-combustible



fire protection

exterior PROFILE options - close-up

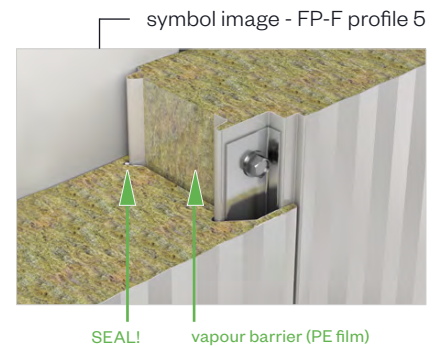
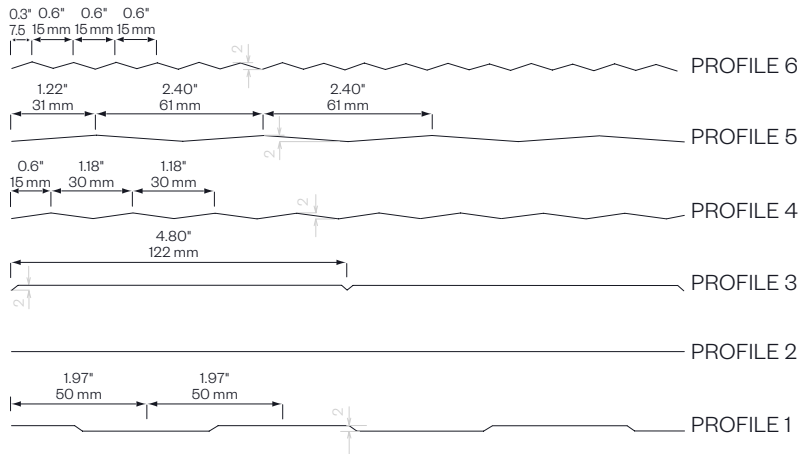

DETAIL/joint geometry

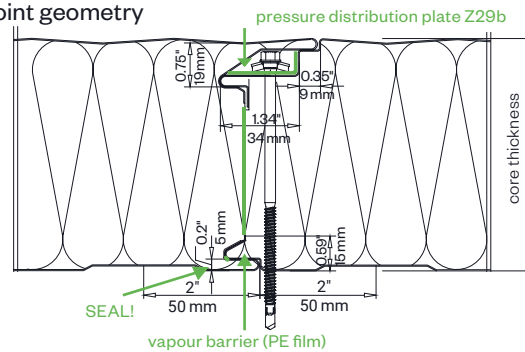

butt joint:
0.08" = 0.08" tolerance
2 mm ± 2 mm tolerance

PANEL TYPE	FP-F 60	FP-F 80	FP-F 100	FP-F 120	FP-F 140	FP-F 150	FP-F 160	FP-F 180	FP-F 200	FP-F 240
core thickness in ≈ inch in mm	2.5" 60	3" 80	4" 100	4.5" 120	5.5" 140	6" 150	6.5" 160	7" 180	8" 200	9.5" 240
R-value thermal performance	9.5	12	15	18	20.5	22	23	26	29	34
weight in lb/ft ² in kg/m ²	3.35 16.38	3.85 18.78	4.34 21.18	4.83 23.58	5.32 25.98	5.75 27.18	5.81 28.38	6.30 30.78	6.80 33.18	7.78 37.98
fire resistance ANSI/UL 263, CAN/ULC-S101	---	---	EI 60	EI 60	EI 60	EI 120	EI 120	EI 120	EI 120	EI 120

MANUFACTURING LENGTHS

39' 2" or 11.95 m (44' 3 1/2" or 13.50 m)

R-VALUE

≈ 3.8 per inch @75°F mean temperature

SPAN WIDTH TABLES

according static tables

PERMANENT TEMPERATURE RESISTANCE

176°F/80°C



fire protection

BRUCHA panel FP-F

facade concealed fastened / non-combustible

DESIGN AND SURFACES Standard - coil-coated, hot-dip galvanised steel sheet

EXTERIOR

- Exposed side 25 µm polyester coating with a PVC protective film (not UV-resistant - protect from direct sunlight).
The film must be removed before installation or immediately afterwards.
- profile 1 = Standard, for other profiles see FP-F PROFILE options
- metal gauge: : 24 ga / 0.6 mm (smaller metal gauge on request)

INTERIOR

- Exposed side 25 µm polyester coating with a PVC protective film (not UV-resistant - protect from direct sunlight).
The film must be removed before installation or immediately afterwards.
- profile 1 = standard (profile 2 and 3 on request)
- metal gauge: 24 ga / 0.6 mm (smaller metal gauge on request)

INSULATION CORE

- structural, web-oriented mineral fibre wool
- securely attached to the sheet steel shell
- density approx. 7.50 lb/ft³ or 120 kg/m³, 8.75 lb/ft³ or 140 kg/m³ available on request

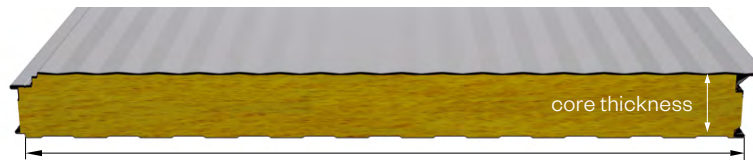

construction width 43.31" or 1100 mm
(39.37" or 1000 mm special width on request)

STANDARD COLORS

in accordance with BASIC color range

PANEL CONNECTION

Tongue and groove system in which the special labyrinth profile allows the screw head to be countersunk and fully covered by the next panel – **covered, concealed mounting**. BRUCHA panel FP-F with mineral wool core can be combined with BRUCHA panel FP with PIR/polyurethane core using an adaptor panel.

TENDER TEXT

download from: brucha.com

EXTERNAL MONITORING

National and international tests and quality standards. We will send the certificates on request.

VAPOUR DIFFUSION

Determined by climatic conditions inside building. Panels must be installed vapour tight.

PANEL INSTALLATION

When working with our products, please follow our installation guidelines at brucha.com/downloads.



brucha.com

Contact:
BRUCHA Corp.
4949 S Syracuse Street, Suite 550
CO 80237 Denver
T: 866.BRUCHA1
M: infousa@brucha.com
bruchaamerica.com

