

BRUCHA panel DP roof

DESIGN AND SURFACES Standard - coil-coated, hot-dip galvanised steel sheet

EXTERIOR

- Exposed side 25 µm polyester coating with a PVC protective film (not UV-resistant - protect from direct sunlight).
The film must be removed before installation or immediately afterwards.
- profile: Trapezoidal profile, 1.65" / 42 mm (according to diagram)
- crown distance: 13.12" / 333.3 mm
- metal gauge: 24 ga / 0.6 mm (smaller metal gauge on request)

INTERIOR

- Exposed side has 25 µm polyester coating without protective PVC film (if required, please specify with order).
- profile 1 = standard (profile 2 and 3 on request)
- metal gauge: 26 ga / 0.5 mm (smaller metal gauge on request)

INSULATION CORE

- **nonhalogen** PIR/polyurethane rigid foam, approx. 96 % closed cells, continuously foamed
- absolutely no chlorofluorocarbons or halogenated chlorofluorocarbons - pentane foam process
- low thermal conductivity
- securely attached to the steel sheet
- density approx. 2.50 lb/ft³ or 40 kg/m³



STANDARD COLORS

in accordance with BASIC color range

PANEL CONNECTION

- External, by overlapping of the corrugations, whereby the non-foamed sheet of a panel is placed over the corresponding section of the next panel.
- On the underside, by special shaping, whereby the complementary profile to the corrugation of one roof panel overlaps the corrugation of the second panel, thus achieving a tight connection.
- Unique **TRIPLE SEALING SYSTEM** (as per diagram) offers optimal condensate protection.
- capillary break (refer drawing)

TENDER TEXT

download from: brucha.com

EXTERNAL MONITORING National and international tests and quality standards. We will send the certificates on request.



brucha.com

Contact:
BRUCHA Corp.
4949 S Syracuse Street,
Suite 550
CO 80237 Denver
T: 866.BRUCHA1
M: infousa@brucha.com
bruchaamerica.com



BRUCHA panel DP roof

PIR+
nonhalogen

iQTec
foam technology®

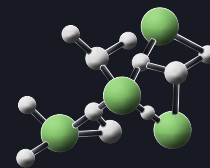

Minimum roof pitch 3° (5.2 %) without transverse joint and penetration.

BRUCHA panel DP with PIR/polyurethane core can be combined with BRUCHA panel DP-F with mineral wool core.

TRAPEZOID PROFILE exterior

close-up

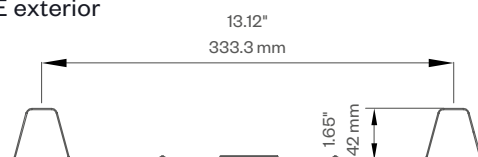

symbol image - DP

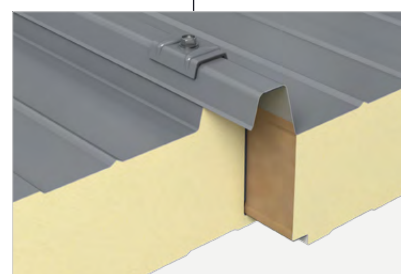

DETAIL/joint geometry

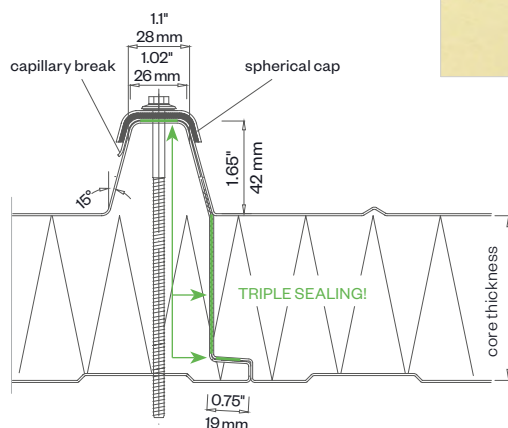

butt joint:
0.08" = 0.08" tolerance
2 mm ± 2 mm tolerance

PANEL TYPE	DP 72	DP 82	DP 92**	DP 102	DP 122	DP 142	DP 162	DP 182	DP 202
core thickness in ≈ inch in mm	1" 30	1.5" 40	2" 50	2.5" 60	3" 80	4" 100	4.5" 120	5.5" 140	6.5" 160
PIR+ non-halogen R-value thermal performance at 75°F	10	13	16	19	25	31	37	43	49
iQTec on request R-value thermal performance at 75°F	10.5	13.5	17	20	26	32.5	39	45	51.5
weight in lb/ft ² in kg/m ²	2.01 9.80	2.09 10.22	2.18 10.63	2.26 11.05	2.44 11.89	2.61 12.72	2.78 13.55	2.95 14.39	3.12 15.22

**DP 92 on request

MANUFACTURING LENGTHS

39' 2" or 11.95 m (44' 3 1/2" or 13.50 m)

R-VALUE

≈ 7.50 per inch @75°F mean temperature
≈ 8.25 per inch @35°F mean temperature

SPAN WIDTH TABLES

according static tables

PERMANENT TEMPERATURE RESISTANCE

176°F/80°C