

BRUCHA[®]Paneel

PIR+ Wall – WP

Visible mounting

Standard DESIGN AND SURFACES

Coil-coated, hot-dip galvanised steel sheet for cold storage and food handling areas – test seal for clean room suitability



EXTERIOR:	<ul style="list-style-type: none">Exposed side 25 µm polyester coating with a PVC protective film (protects against solar radiation). The film must be removed no later than 10 weeks after the production date (visible on the longitudinal joint of the panel).Profile 1 = Standard, for other profiles see WP PROFILE optionsMetal gauge: 0.236in (smaller metal gauge on request)
INTERIOR:	<ul style="list-style-type: none">Exposed side 25 µm polyester coating with a PVC protective film (protects against solar radiation). The film must be removed no later than 10 weeks after the production date (visible on the longitudinal joint of the panel).Profile 1 = standard (profile 2 and 3 on request)Metal gauge: 0.196in (smaller metal gauge on request)
INSULATION CORE:	<ul style="list-style-type: none">PIR+/polyurethane rigid foam manufactured in continuously foamed process with reduced thermal conductivity of 0.019 W/mK, approx. 95 % closed cells, securely attached to the steel sheetDensity approx. 2.5 lb/ft³, absolutely no chlorofluorocarbons or halogenated chlorofluorocarbons – pentane foam process
FIRE BEHAVIOUR:	<ul style="list-style-type: none">In line with EN 13501-1, Euroclass Bs1d0
STANDARD COLOURS:	<ul style="list-style-type: none">In accordance with BASIC colour range
PANEL CONNECTION:	<ul style="list-style-type: none">“Tongue and groove system” and from 3 15/16in thickness with labyrinth system. The exterior and interior sheet steel covers are not connected to each other. The integrated seal ensures optimum wind proofing. The panels interlink precisely with no thermal bridge.
SPECIFICATIONS:	Download from www.brucha.com
EXTERNAL MONITORING:	National and international tests, quality standards



We will be happy to send certificates on request!



BRUCHAPaneel®

PIR+ Wall – WP

Visible mounting



Exterior PROFILE options

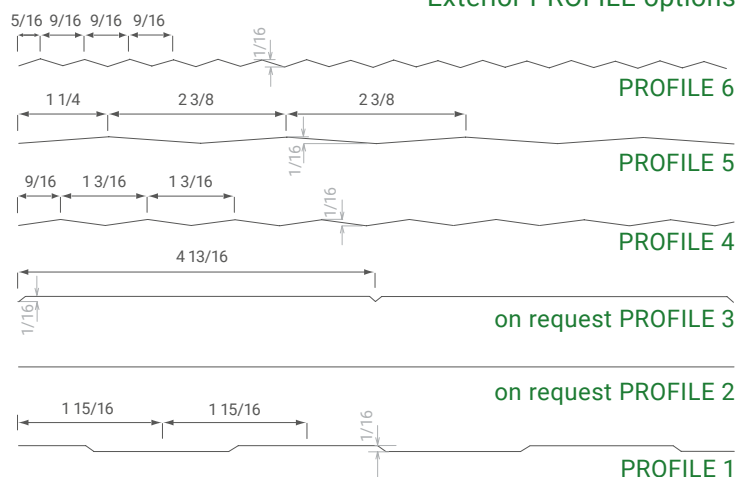

BRUCHAPaneel panel WP with polyurethane core can be combined with BRUCHAPaneel WP-F with mineral wool core using an adaptor panel.

Panel type	WP40	WP50	WP60	WP80	WP100	WP120	WP140	WP150*	WP160	WP170	WP180*	WP200	WP220*	WP250*
Core thickness (inches)	1 1/2	2	2 1/4	3	3 15/16	4 3/4	5 1/2	5 7/8	6 1/4	6 3/4	7 1/8	7 7/8	8 5/8	9 7/8
R-Value ((sq ft • °F • hr)/ BTU; incl. joints)	10.7	13.6	17.2	22.6	28.5	34.2	40.0	42.7	45.8	50.7	51.2	57.4	63.1	69.3
Weight (lb/sq ft)	2.23	2.32	2.40	2.56	2.73	2.89	3.05	3.14	3.22	3.30	3.38	3.55	3.71	3.96

*on request, from 5381sq ft (1937 1/2 from 3229 1/6sq ft), max. production length 52 1/2ft

Manufacturing tolerances:	In line with EN 14509
Manufacturing lengths:	Max. 60 3/8ft (extra-long transport from 44 5/8ft)
Span width tables:	From Dr Wilhelm Pilgram – Vienna
Sound insulation:	26 dB at 2 3/8in / 3 1/8in 27 dB from 3 15/16in core thickness
Temperature resistance:	194°F

Joint geometry up to 3 1/8in core thickness /detail

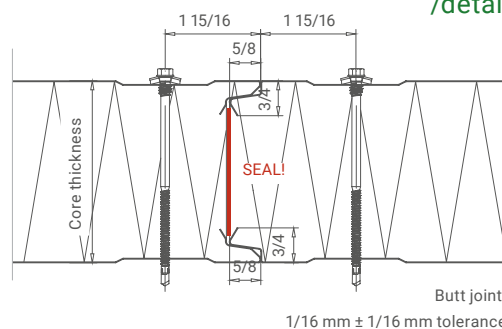

Joint geometry from 3 15/16in core thickness /detail

