

## Fire protection roof – DP-F

### Standard DESIGN AND SURFACES

Coil-coated, hot-dip galvanised steel sheet

EXTERIOR:	<ul style="list-style-type: none"> <li>Exposed side 25 µm polyester coating with a PVC protective film (protects against solar radiation). The film must be removed no later than 10 weeks after the production date (visible on the longitudinal joint of the panel).</li> <li>Profile: Trapezoidal profile, 1 5/8in (according to diagram)</li> <li>Crown distance: 13 1/8in</li> <li>Metal gauge: 0.236in (smaller metal gauge on request)</li> </ul>
INTERIOR:	<ul style="list-style-type: none"> <li>Exposed side has 25 µm polyester coating without protective PVC film (if required, please specify with order).</li> <li>Profile 1 = standard (profile 2 and 3 on request)</li> <li>Metal gauge: 0.236in (smaller metal gauge on request)</li> </ul>
INSULATION CORE:	<ul style="list-style-type: none"> <li>Structural, web-oriented mineral fibre wool</li> <li>Securely attached to the sheet steel shell</li> <li>Density approx. 7 1/2lb/ft<sup>3</sup>, 8 3/4lb/ft<sup>3</sup> available on request</li> </ul>
FIRE BEHAVIOUR:	<ul style="list-style-type: none"> <li>In accordance with EN 13501-1, <b>Euroclass A2s1d0, non-combustible</b></li> </ul>
STANDARD COLOURS:	<ul style="list-style-type: none"> <li>In accordance with BASIC colour range</li> </ul>
PANEL CONNECTION:	<ul style="list-style-type: none"> <li>External, by overlapping of the profiles, whereby the non-foamed sheet of a panel is placed over the corresponding section of the next panel.</li> <li>On the underside, by special shaping, whereby the complementary profile to the profile of one roof panel overlaps the profile of the second panel. The included seals offer additional reliability, achieving a reliably tight connection.</li> <li>Capillary break (acc. drawing).</li> </ul>
SPECIFICATIONS:	Download from <a href="http://www.brucha.com">www.brucha.com</a>
EXTERNAL MONITORING:	National and international tests, quality standards
VAPOUR DIFFUSION:	<ul style="list-style-type: none"> <li>Determined by climatic conditions inside building. Panels must be installed vapour tight.</li> </ul>
PANEL INSTALLATION:	<ul style="list-style-type: none"> <li>When working with our products, please follow our installation guidelines at <a href="http://www.brucha.com/downloads">www.brucha.com/downloads</a>.</li> </ul>



We will be happy to send certificates on request!

# BRUCHAPaneel®

## Fire protection roof – DP-F

Minimum roof pitch 3° (5.2%) without transverse joint and penetration.

**BRUCHAPaneel panel DP-F** with mineral wool core can be combined with BRUCHAPaneel DP with polyurethane core.

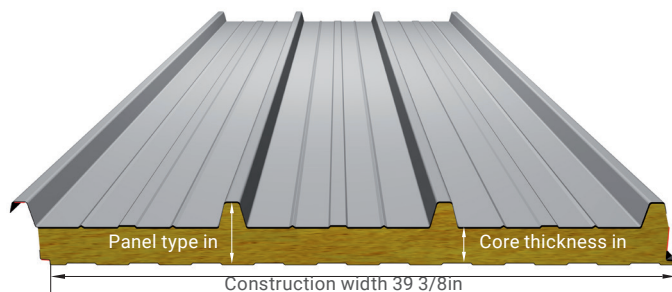

TRAPEZOID PROFILE exterior

Cut-out

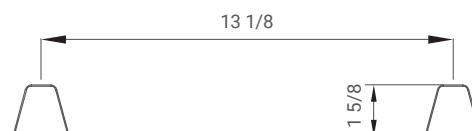

Panel type	DP-F102	DP-F122	DP-F142	DP-F162	DP-F182	DP-F192	DP-F202	DP-F222	DP-F242
Core thickness (inches)	2 3/8	3 1/8	3 15/16	4 3/4	5 1/2	5 15/16	6 5/16	7 1/16	7 7/8
R-Value ((sq ft • °F • hr)/BTU; incl. joints)	8.7	11.4	13.9	16.2	18.9	20.3	21.8	23.7	27.0
Weight (lb/sq ft)	3.83	4.28	5.00	5.51	6.05	6.31	6.54	6.89	7.44
Fire resistance*	REI 30	REI 90	REI 90	REI 90	REI 90	REI 90	REI 90	REI 90	REI 90

\*Certificates must be checked for the usage case in question (horizontal/vertical/span width etc.).

<b>Manufacturing tolerances:</b>	In line with EN 14509
<b>Manufacturing lengths:</b>	Max. 51 1/5ft (extra-long transport from 44 5/8ft) ATTENTION! Danger of kinking due to heavy weight in the case of long panels!
<b>Span width tables:</b>	From Dr Wilhelm Pilgram – Vienna
<b>Sound insulation:</b>	32 dB (frequency dependent)
<b>Fire behaviour:</b>	In accordance with EN 13501-1, Euroclass A2s1d0, non-combustible

A notch in the eave area is required in order to rule out any possibility of the sheet metal shell lifting up from the insulation body (available at a surcharge).

Similarly, a drip cap should be fitted in the eave area so as to prevent a capillary effect (only possible on the construction site). These measures prevent the formation of corrosion between the sheet metal shell and the insulation. We recommend to cover the core in the end with (part No. Z 13b) cog sheet.

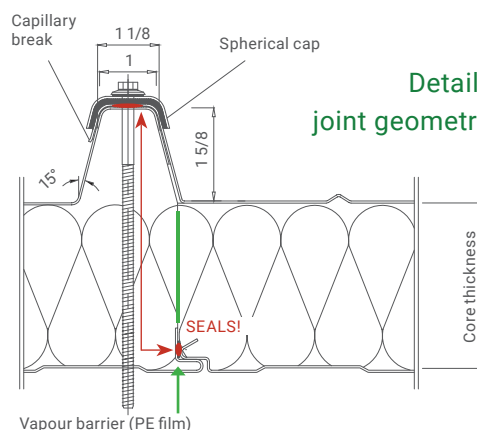

Detail/  
joint geometry

